

Intara CX

Article number: 51410023

LIGHT TECHNOLOGY

LED	LED
Light colour	SpecialMeat
Luminous flux	1620 lm
System power	41 W
Luminaire Efficiency	40 lm/W
Reflector	Downlight
Beam angle	60°
Controller	On/Off

LUMINAIRE

Weight	0.67 kg
Protection rating . class	IP 20 . III
Luminaire colour	white

OPTIONEEL

Front ring with RAL / NCS, emergency light function for central supply, fire protection cover (up to 34 W), ceiling reinforcing profile for modular ceiling, reduction ring

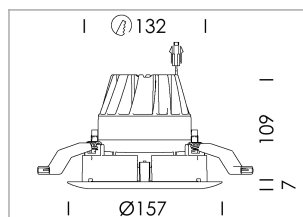

Recessed downlight with LED, rated life of the LED L80/B10 > 50000 h, colour rendering index CRI > 82, chromaticity tolerance 2 SDCM (initial), reflector with homogeneous light distribution pattern, diffuser lens, translucent, darklight reflector, aluminium, metallised, highgloss, luminaire head die-cast aluminium, powder-coated, ; mounting ring die-cast aluminum, front ring and coverblind plastic, white, separate driver unit

76500037 driver unit, On/Off, 220-240 V / 50-60 Hz, 1050 mA, camera-compatible, up to 2.5 KV interference resistance, SELV, max. 22 luminaires per circuit (B16A fuse)

76500042 driver unit, DALI, 220-240 V / 50-60 Hz, 1050 mA, with GST18/5-pin connector, incl. 5-conductor feed-through wiring, camera-compatible, up to 2.5 KV interference resistance, SELV, max. 22 luminaires per circuit (B16A fuse)

76500124 driver unit, Casambi, 220-240 V / 50-60 Hz, 1050 mA, camera-compatible, up to 2.5 KV interference resistance, SELV, max. 23 luminaires per circuit (B16A fuse)

Note: All data are typical values. System features may change with product improvements due to technical advances. Errors excepted.

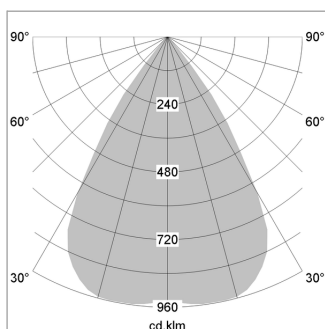

1.0 m	1.28	1526.9
2.0 m	2.56	381.7
3.0 m	3.84	169.7
4.0 m	5.12	95.4
5.0 m	6.40	61.1
Ø (m)		E0(0°) [lx]

