

## Intara CX

Article number: 51410014

### LIGHT TECHNOLOGY

LED	COB
Light colour	835
Luminous flux	1680 lm
System power	17 W
Luminaire Efficiency	99 lm/W
Reflector	Downlight
Beam angle	60°
Controller	On/Off

### LUMINAIRE

Weight	0.67 kg
Protection rating . class	IP 20 . III
Luminaire colour	white

### OPTIONEEL

Front ring with RAL / NCS, emergency light function for central supply, fire protection cover (up to 34 W), ceiling reinforcing profile for modular ceiling, reduction ring

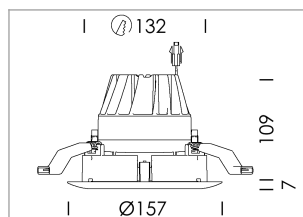

Recessed downlight with LED, rated life of the LED L80/B10 > 50000 h, colour rendering index CRI > 80, chromaticity tolerance 2 SDCM (initial), reflector with homogeneous light distribution pattern, diffuser lens, translucent, darklight reflector, aluminium, metallised, highgloss, luminaire head die-cast aluminium, powder-coated, ; mounting ring die-cast aluminum, front ring and coverblind plastic, white, separate driver unit

76500050 driver unit, On/Off, 220-240 V / 50-60 Hz, 400 mA, camera-compatible, up to 2.5 KV interference resistance, SELV, max. 34 luminaires per circuit (B16A fuse)

76500051 driver unit, DALI, 220-240 V / 50-60 Hz, 400 mA, with GST18/5-pin connector, incl. 5-conductor feed-through wiring, camera-compatible, up to 2.5 KV interference resistance, SELV, max. 24 luminaires per circuit (B16A fuse)

76500121 driver unit, Casambi, 220-240 V / 50-60 Hz, 400 mA, camera-compatible, up to 2.5 KV interference resistance, SELV, max. 35 luminaires per circuit (B16A fuse)

Note: All data are typical values. System features may change with product improvements due to technical advances. Errors excepted.

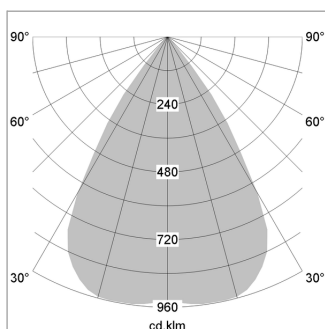

1.0 m	1.28	1583.4
2.0 m	2.56	395.9
3.0 m	3.84	175.9
4.0 m	5.12	99.0
5.0 m	6.40	63.3
Ø (m)		E0(0°) [lx]

